

## Step 1. Attach the Wall Mount Bracket

Insert the tabs on the wall mount bracket into the slots in the first and third rows on the back of the IP phone. And then slide the wall mount bracket rightwards to lock it in place.

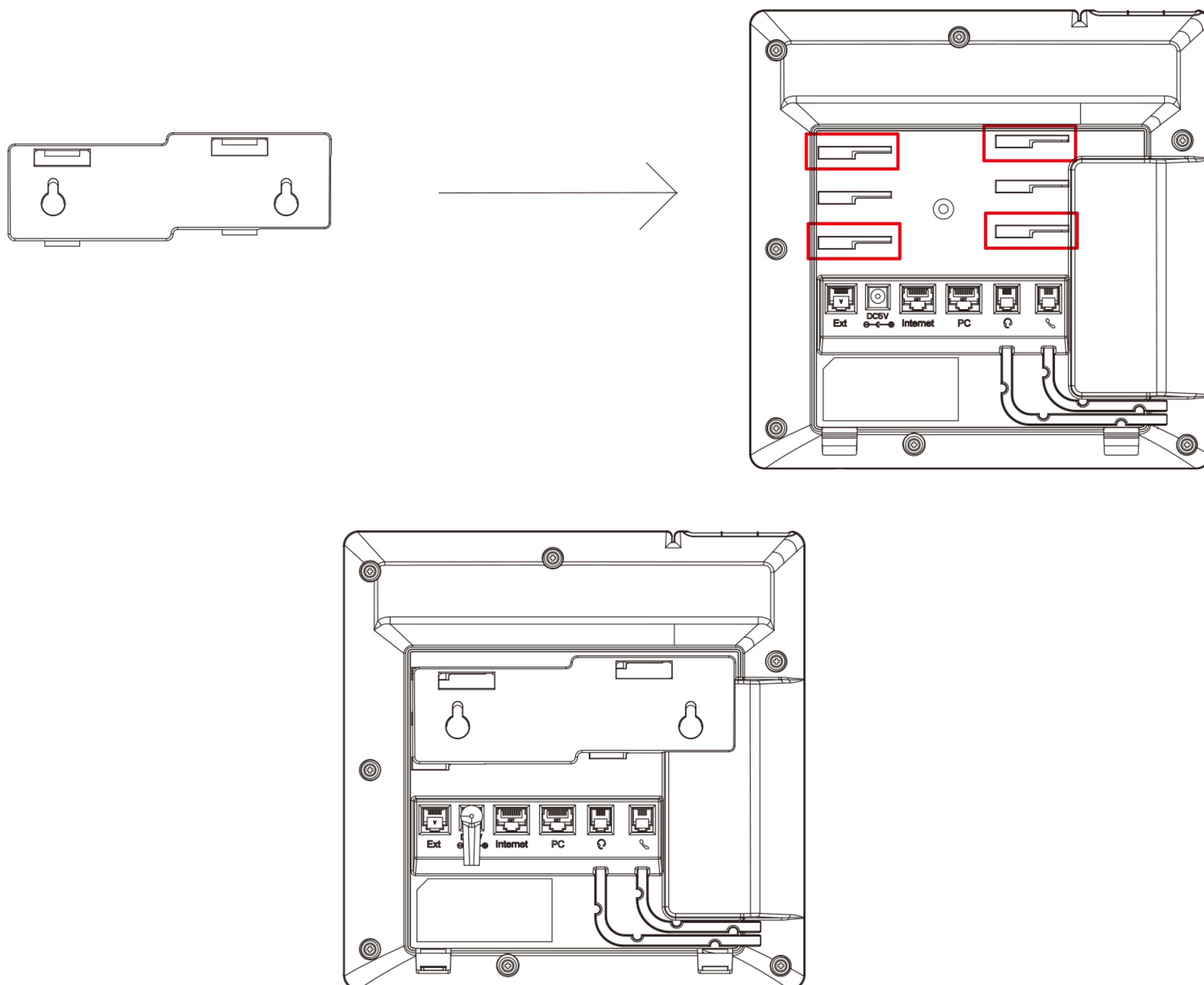

## Step 2. Drill assembly holes in the wall

Locate two assembly holes horizontally with a spacing of 103.5mm.

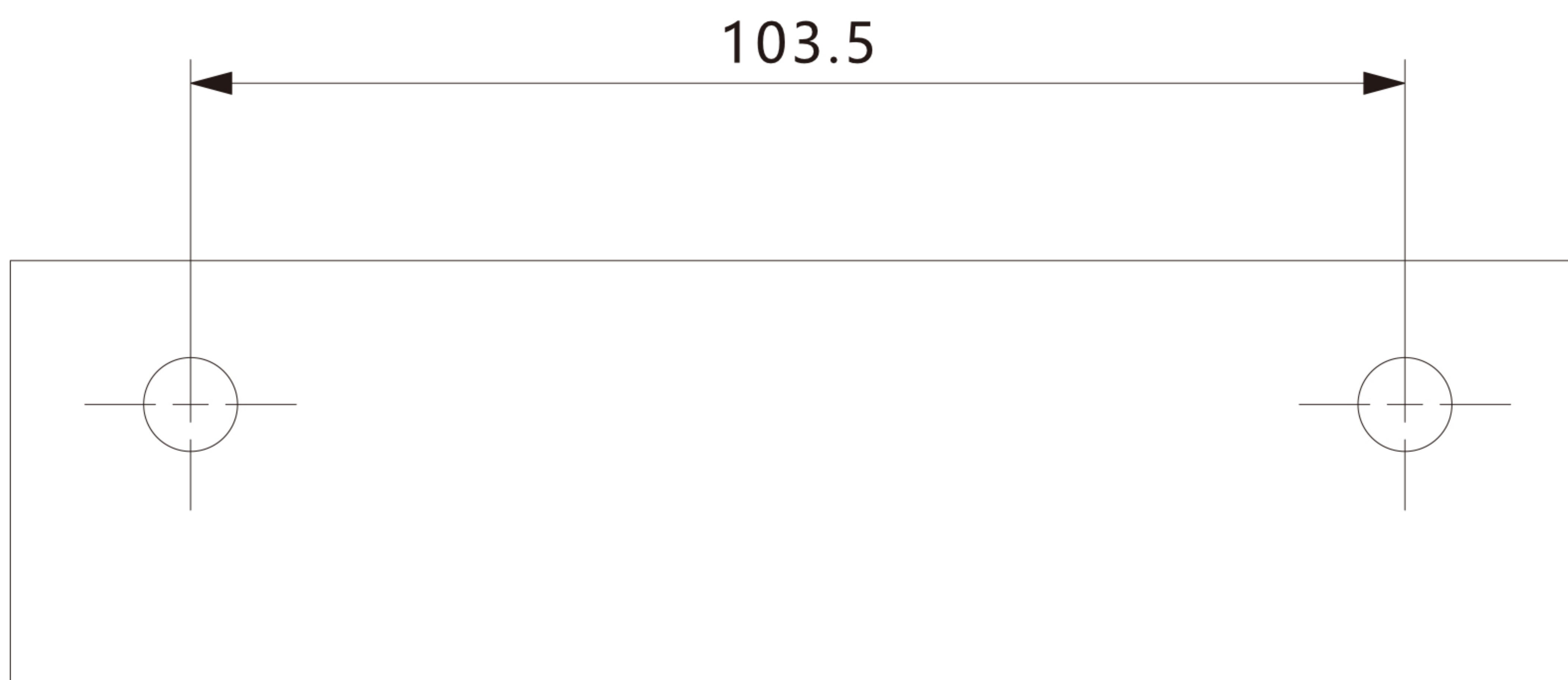

Note:  $\Phi 6 \times 40$  expansion tube with M4\*40 tapping screw is recommended

### Step 3. Mount the phone to the wall

Hang the wall socket of the wall mount bracket downwards onto screws mounted in the wall.

